

## Short steel nut blank, cylindrical KSM

Suitable for clamping operations, manual positioning and mounting.  
Not suitable for motion drives because the steel/steel friction tends to seizure.

Further processing: The thread serves as reference for precise machining and assembly.

Material: free-cutting steel 1.0718 (9 SMn 28K).

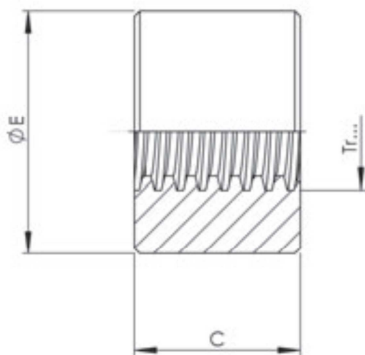

Type	E [mm]	C [mm]	Weight [kg]
KSM Tr 10x2	22	15	0,037
KSM Tr 10x3	22	15	0,036
KSM Tr 12x3	26	18	0,064
KSM Tr 14x3	30	21	0,096
KSM Tr 14x4	30	21	0,096
KSM Tr 16x4	36	24	0,16
KSM Tr 18x4	40	27	0,22
KSM Tr 20x4	45	30	0,31
KSM Tr 22x5	45	33	0,33
KSM Tr 24x5	50	36	0,45
KSM Tr 26x5	50	39	0,47
KSM Tr 28x5	60	42	0,76
KSM Tr 30x6	60	45	0,79
KSM Tr 32x6	60	48	0,81
KSM Tr 36x6	75	54	1,5
KSM Tr 40x7	80	60	1,9
KSM Tr 50x8	90	75	2,7
KSM Tr 60x9	100	90	3,7
KSM Tr 70x10	110	105	4,9
KSM Tr 80x10	120	120	6,4